



Flat 9 1 Silvester Road

, Waterloooville, PO8 8TD

£975 Per month



Signature Properties are delighted to offer this spacious one-bedroom apartment located on Silvester Road, Cowplain, just a short stroll from local shops and amenities.

The accommodation comprises a bright open-plan lounge/kitchen, fitted with integrated oven and hob, fridge/freezer, dishwasher, and washing machine. The property further benefits from a double bedroom with a large fitted wardrobe and a modern shower room.

Additional features include double glazing, gas central heating, and one allocated parking space. Water rates are charged at £48.00 per calendar month.

Please note that floor plan measurements may not be accurate; contact us today to arrange a viewing.

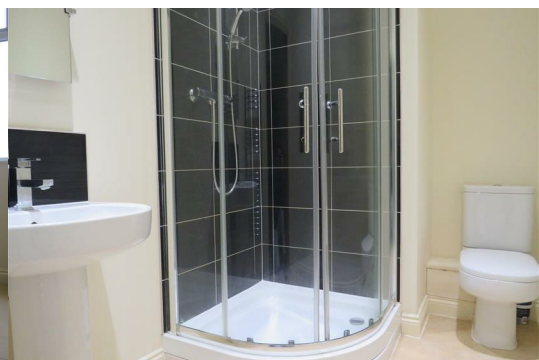

Area Map



Floor Plans

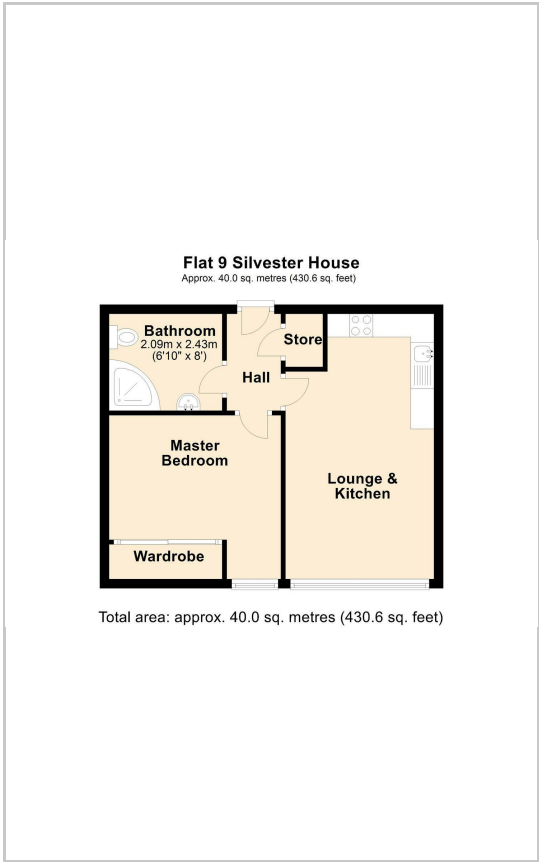

Energy Efficiency Graph

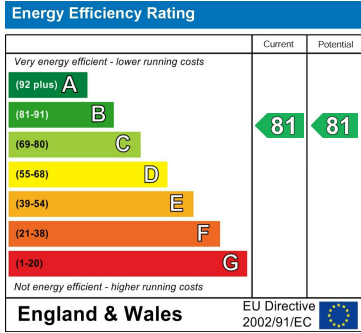

These particulars, whilst believed to be accurate are set out as a general outline only for guidance and do not constitute any part of an offer or contract. Intending purchasers should not rely on them as statements of representation of fact, but must satisfy themselves by inspection or otherwise as to their accuracy. No person in this firms employment has the authority to make or give any representation or warranty in respect of the property.